



# the mulberry

2 BEDROOMS

OVERALL 66.14 M<sup>2</sup> | 712 FT<sup>2</sup>

A hallway leads to the delightful kitchen-diner to the right and the double bedroom 2 to the left. Straight ahead you have the main double bedroom and the amply sized lounge with bi-fold doors.





# the mulberry

2 BEDROOMS

OVERALL 66.14 M<sup>2</sup> | 712 FT<sup>2</sup>

	Metric (m)	Imperial
Living	3.55 x 4.74	11'7" x 15'6"
Kitchen / Dining	3.55 x 4.13	11'7" x 13'6"
Bed 1	3.92 x 3.32	12'10" x 10'10"
Bed 2	2.67 x 3.23	8'9" x 10'7"

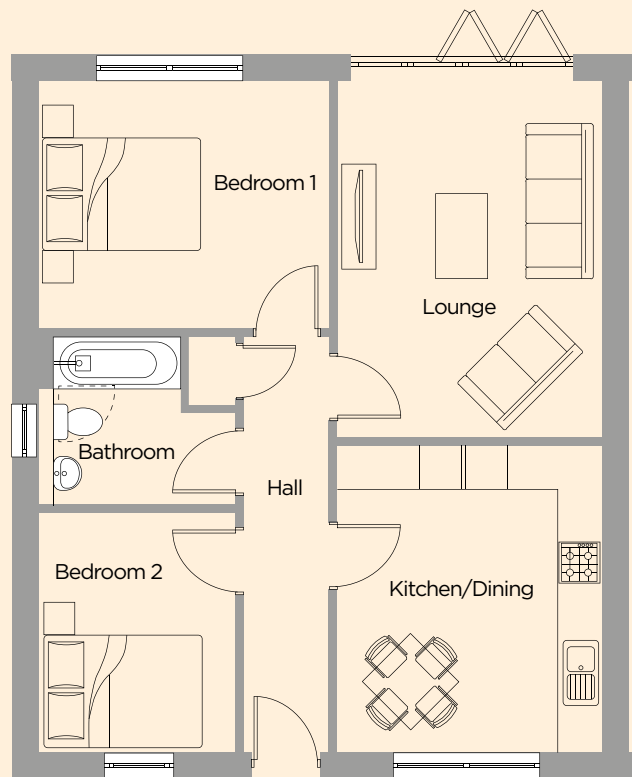

All travel times, distances, companies, businesses and trading names are believed to be correct at the time of going to print, but any prospective buyer should make their own enquiries. All materials and kitchen/bathroom layouts are indicative only and the final layout, materials, colour and external elevations are subject to change. Whilst every effort has been made to ensure that the information contained in this brochure is correct, it is designed specifically as a guide and Ascent Homes reserves the right to amend the specification as necessary and without notice. This does not constitute or form any part of a contract of sale. September 2022.